

PARTS LIST FOR MODEL 0581

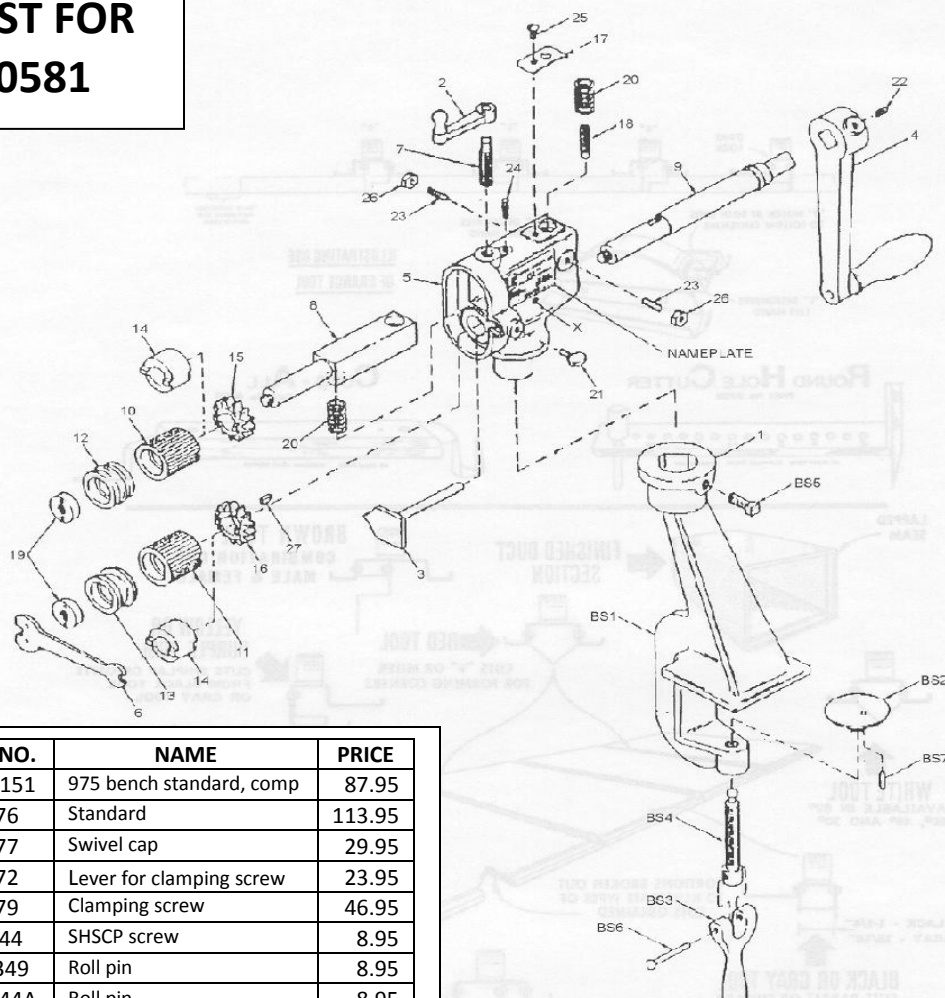

KEY	PART NO.	NAME	PRICE
1	BM10151	975 bench standard, comp	87.95
BS1	10176	Standard	113.95
BS2	10177	Swivel cap	29.95
BS3	10272	Lever for clamping screw	23.95
BS4	10179	Clamping screw	46.95
BS5	WS644	SHSCP screw	8.95
BS6	WS2349	Roll pin	8.95
BS7	WC1544A	Roll pin	8.95
2	A7809	Adjusting screw handle	69.95
3	BM10580	Gauge assembly	45.95
4	BM5843	Hand crank assembly	97.95
5	10565	Frame	332.95
6	10154	Spanner wrench	39.95
7	10451	Adjusting screw	
8	10566	Upper arbor	111.00
9	10567	Lower arbor	105.95
10	10568	Upper crimping roll	77.00
11	10569	Lower crimping roll	77.00
12	10570	Upper beading roll	44.95
13	10571	Lower beading roll	44.95
14	10572	Spacing collar	24.95

KEY	PART NO.	NAME	PRICE
15	10573	Upper conn. gear	97.95
16	10574	Lower conn. gear	105.00
17	10575	Cover	11.95
18	10576	Pivot screw	22.95
19	10578	Roll nut	32.95
20	10581	Spring	8.95
21	WS1961	Thumb screw	8.95
22	WS835	Socket set screw	8.95
23	WS715	Headless set screw	8.95
24	WS702	Headless set screw	8.95
25	WS443	Button head cap screw	8.95
26	WS1332	Check nut	8.95
27	7707	Lower arbor key	14.95

The description and price for the 0581 are on page 35.